

SHOPS AT NORTHWEST CROSSINGS

US Highway 2817 West State Street • Grand Island, NE 68803



GLA 79,714 sf • Anchor Tenants: Petco - Shoe Carnival - Dress Barn - Beth Bath & Beyond

Located in Grand Island, Hall County, Nebraska adjacent to the Grand Island Mall. The center is located on US 281 which is the main retail corridor and underwent a major renovation in 2013

	1 Mile	3 Miles	5 Miles
Total Population	4,481	14,802	18,546
Average Household Income	\$37,659	\$42,575	\$45,201



For Information contact:

Bob Sutton
Chief Investment Officer
260-426-4704
bsutton@eigfw.com

127 W. Berry Street
Suite 300
Fort Wayne, IN 46802

Visit our website for additional information and locations: www.equityinvestmentgroup.com

SHOPS AT NORTHWEST CROSSINGS

US Highway 281 West State Street • Grand Island, NE 68803

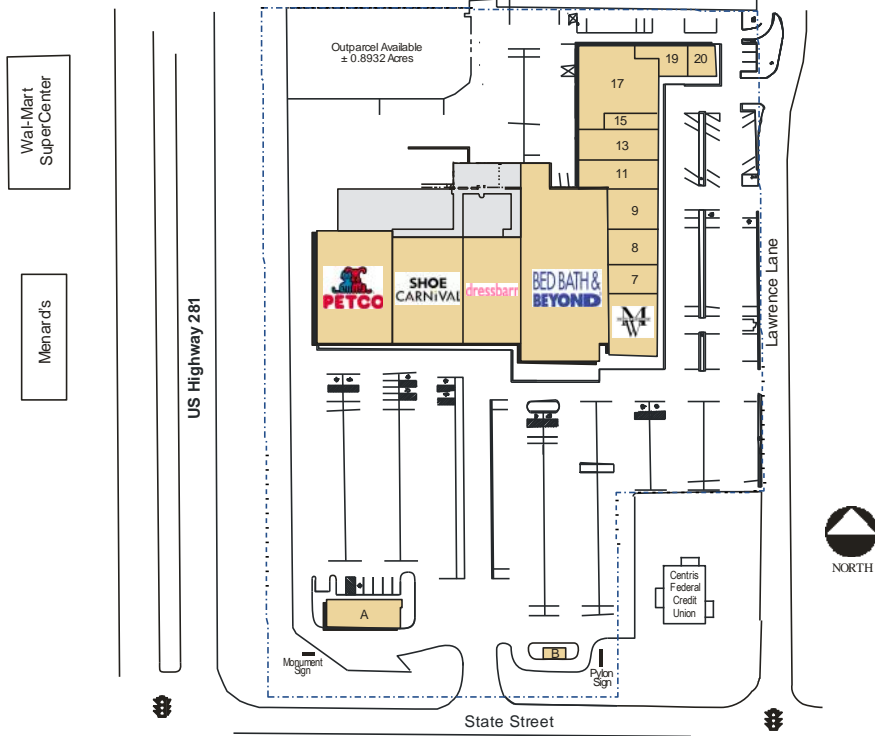

Gross Leasable Area: 79,714 S.F.

1	PETCO	12,500 S.F.	11	SOUTH BEACH TANNING	2,800 S.F.
2	SHOE CARNIVAL	10,000 S.F.	13	AVAILABLE	3,400 S.F.
3	DRESS BARN	7,950 S.F.	15	REJUVENATION SALON	1,072 S.F.
4	BED, BATH & BEYOND	20,142 S.F.	17	AVAILABLE	6,252 S.F.
5	MEN'S WEARHOUSE	4,000 S.F.	19	AVAILABLE	1,803 S.F.
7	ONEMAIN FINANCIAL	1,800 S.F.	20	LITTLE CAESAR'S PIZZA	1,300 S.F.
8	BIG RED TREATS	1,400 S.F.	A	FIREHOUSE SUBS	2,415 S.F.
9	ISLAND NAIL & SPA	2,880 S.F.	B	SCOOTER'S COFFEE	

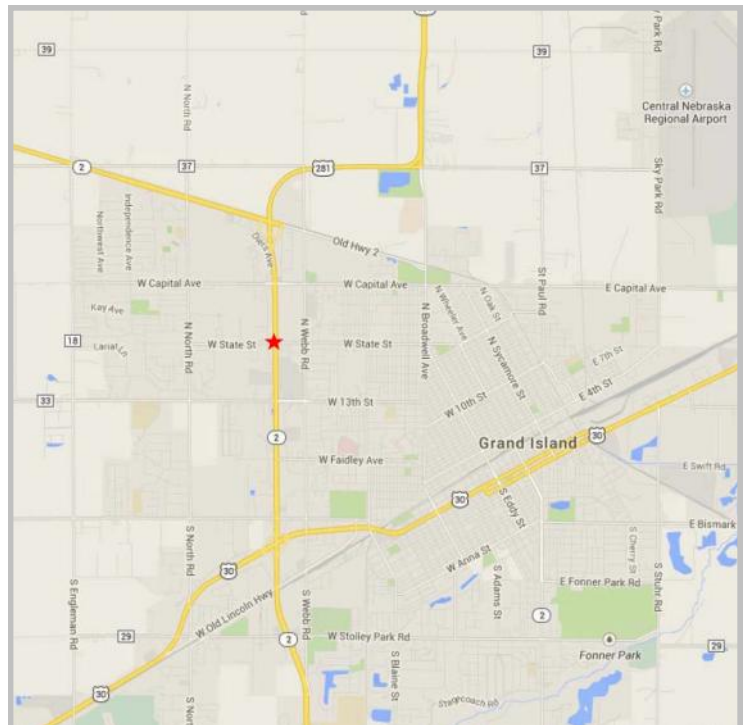
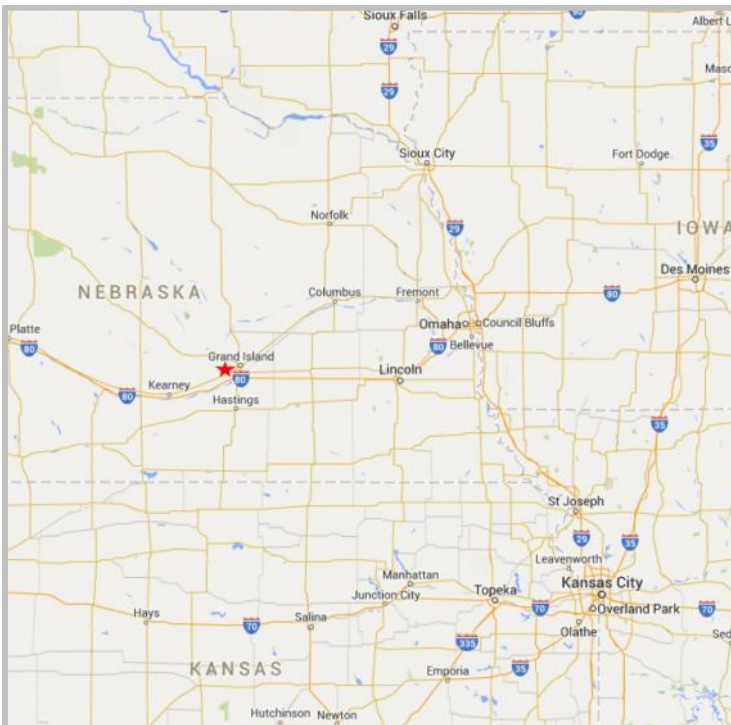

For Information contact:

Bob Sutton
Chief Investment Officer
260-426-4704
bsutton@eigfw.com

127 W. Berry Street
Suite 300
Fort Wayne, IN 46802

Visit our website for additional information and locations: www.equityinvestmentgroup.com