

CITIZEN'S SQUARE PARKING

225 E. Wayne Street • Fort Wayne, IN 46802



± 0.809 acres—located on the corner of Wayne Street and Clinton Street in downtown Fort Wayne; directly across the street from Citizens Square.

	1 Mile	5 Miles	10 Miles
Total Population	13,675	91,156	177,882
Average Household Income	\$36,377	\$43,168	\$48,025



For Information contact:

Tim Rietdorf

Vice President Property Mgmt.

260-426-4704 x308

trietdorf@eigfw.com

127 W. Berry Street

Suite 300

Fort Wayne, IN 46802

Visit our website for additional information and locations: www.equityinvestmentgroup.com

CITIZEN'S SQUARE PARKING

225 E. Wayne Street • Fort Wayne, IN 46802

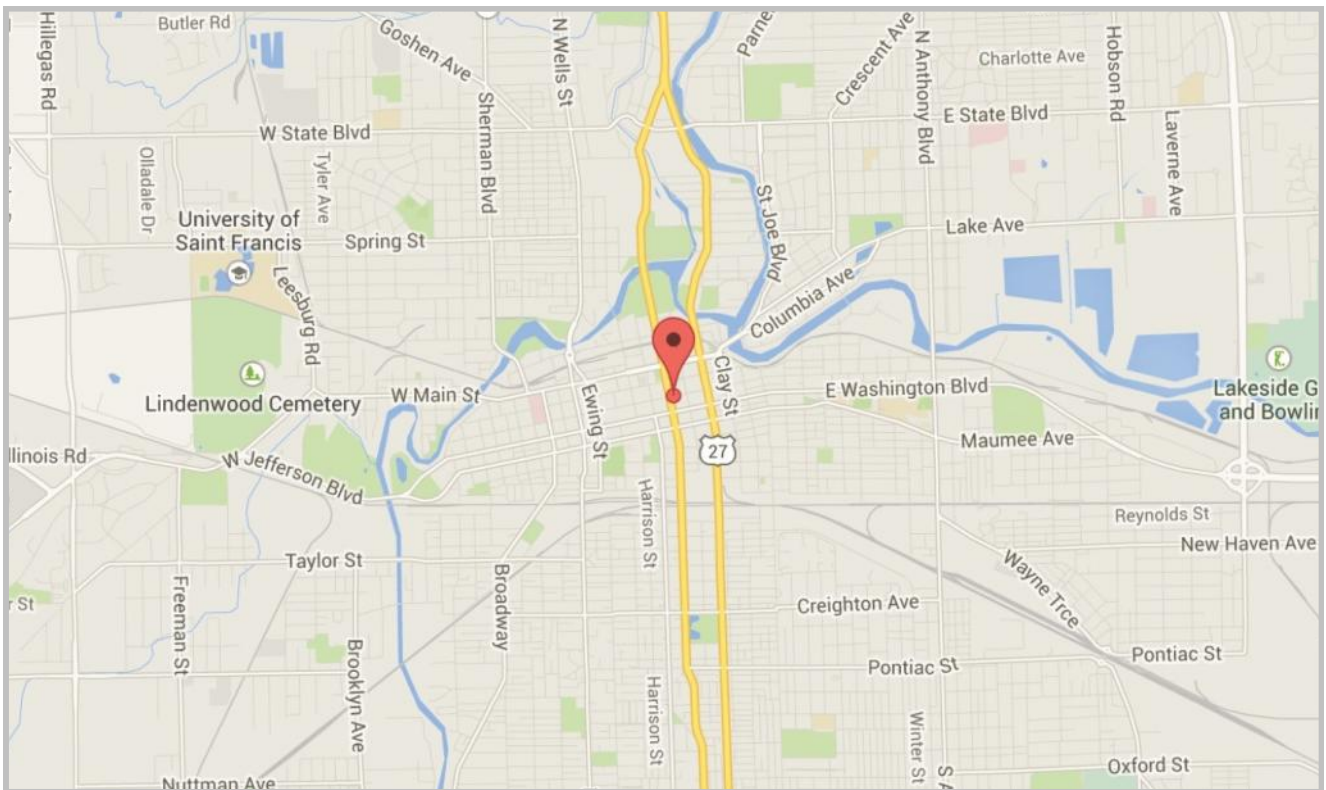
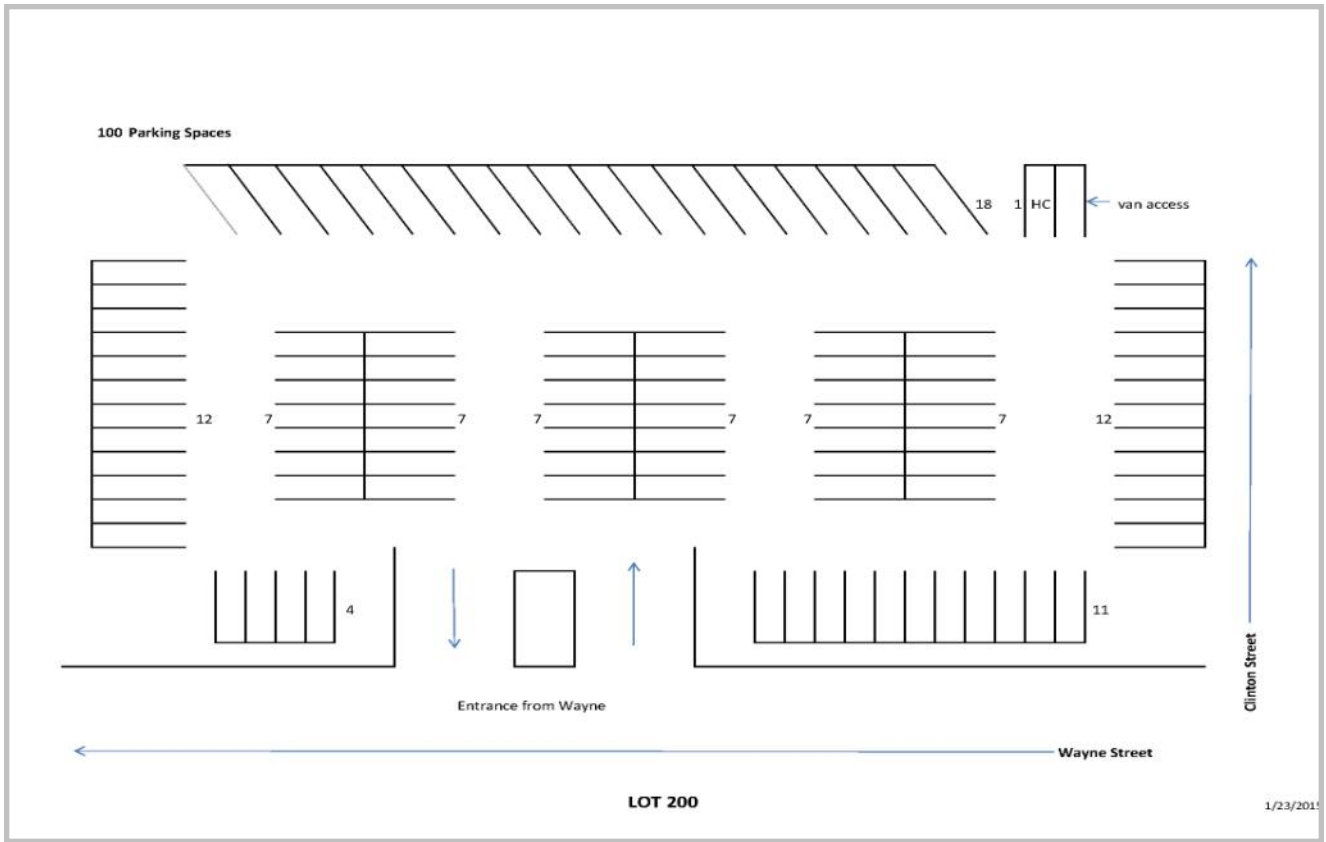

For Information contact:

Tim Rietdorf

Vice President Property Mgmt. 127 W. Berry Street

260-426-4704 x308 Suite 300

trietdorf@eigfw.com

Fort Wayne, IN 46802

Visit our website for additional information and locations: www.equityinvestmentgroup.com